

First Login to Your New Microsoft 365 Powered Computer Account

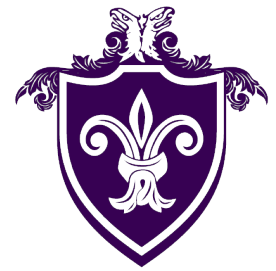

This guide provides step-by-step instructions on how to log in to a new Microsoft 365 powered computer account. It includes tips for a smooth login process and highlights the importance of rebooting the computer before starting. By following these steps, users can easily access their new account and begin using Microsoft products.



Tip! Reboot your computer before you start to ensure that it's fully ready to add your new account.



Do not proceed if you are using a government or personal computer.

1

Start by keying Ctrl + Alt + Delete to unlock the computer

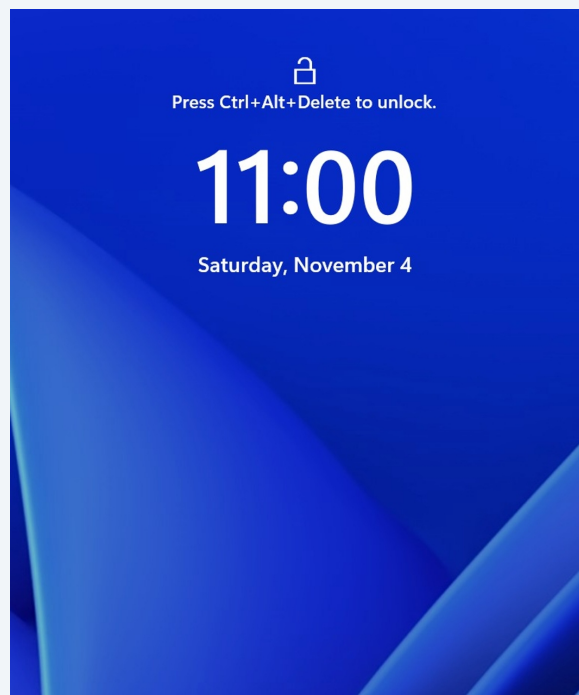

2 Select OK

-Odyssey routinely intercepts and monitors communications on this IS for purposes including, but not limited to, penetration testing, network operations and defense, personnel misconduct (PM), law enforcement (LE), and counterintelligence (CI) investigations.
-At any time, Odyssey may inspect and seize data stored on this IS.
-Communications using, or data stored on, this IS are not private, are subject to routine monitoring, interception, and search, and may be disclosed or used for any Odyssey authorized purpose.
-This IS includes security measures (e.g., authentication and access controls) to protect Odyssey interests--not for your personal benefit or privacy.
-Notwithstanding the above, using this IS does not constitute consent to PM, LE or CI investigative searching or monitoring of the content of privileged communications, or work product, related to personal representation or services by attorneys, psychotherapists, or clergy, and their assistants. Such communications and work product are private and confidential. See IT Rules of the Road for details.

OK

3 Select "Other User"

Bobby King

Password

TOTP →

Bobby King

Matthew Lord

Testy McTesterson

Other user



If "Other User" or the Key Icon is not available contact the Help Desk for assistance.

4 Select Sign-In Options

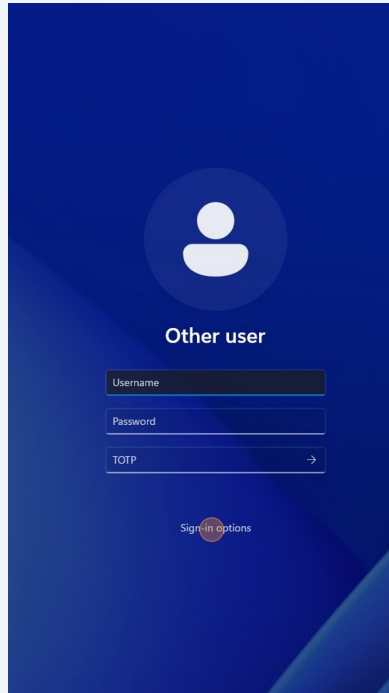

5 Select the Key icon

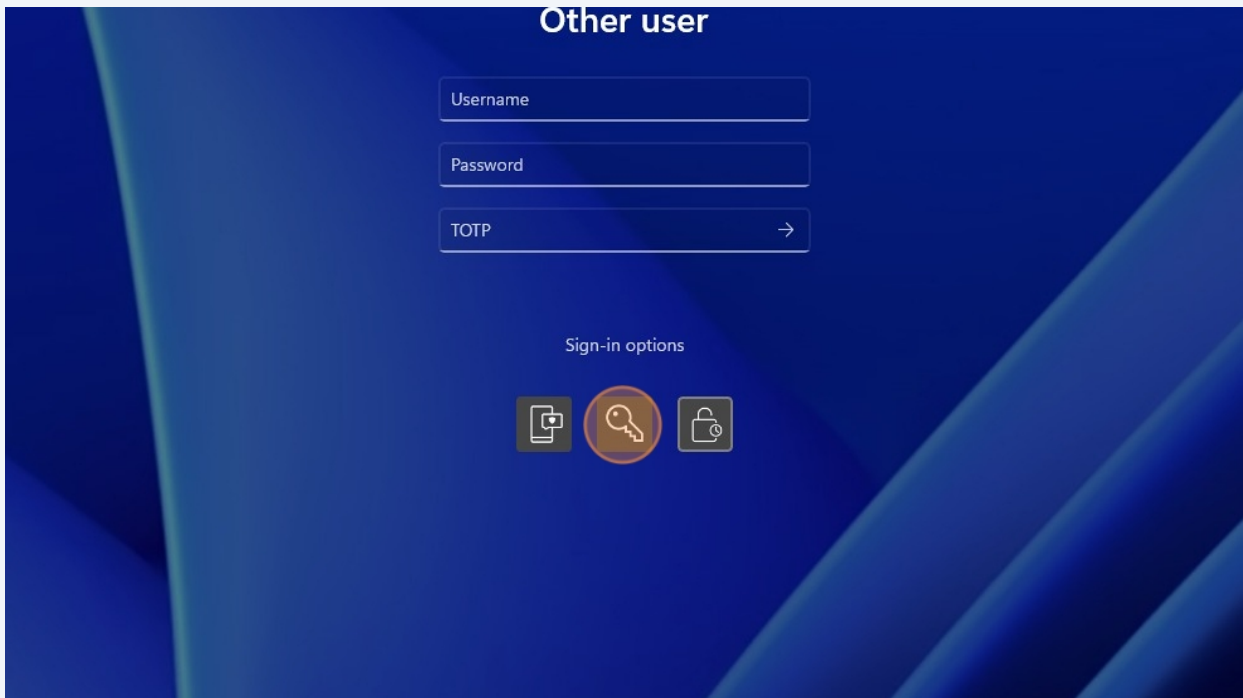

6 Enter your Email Address and your password.

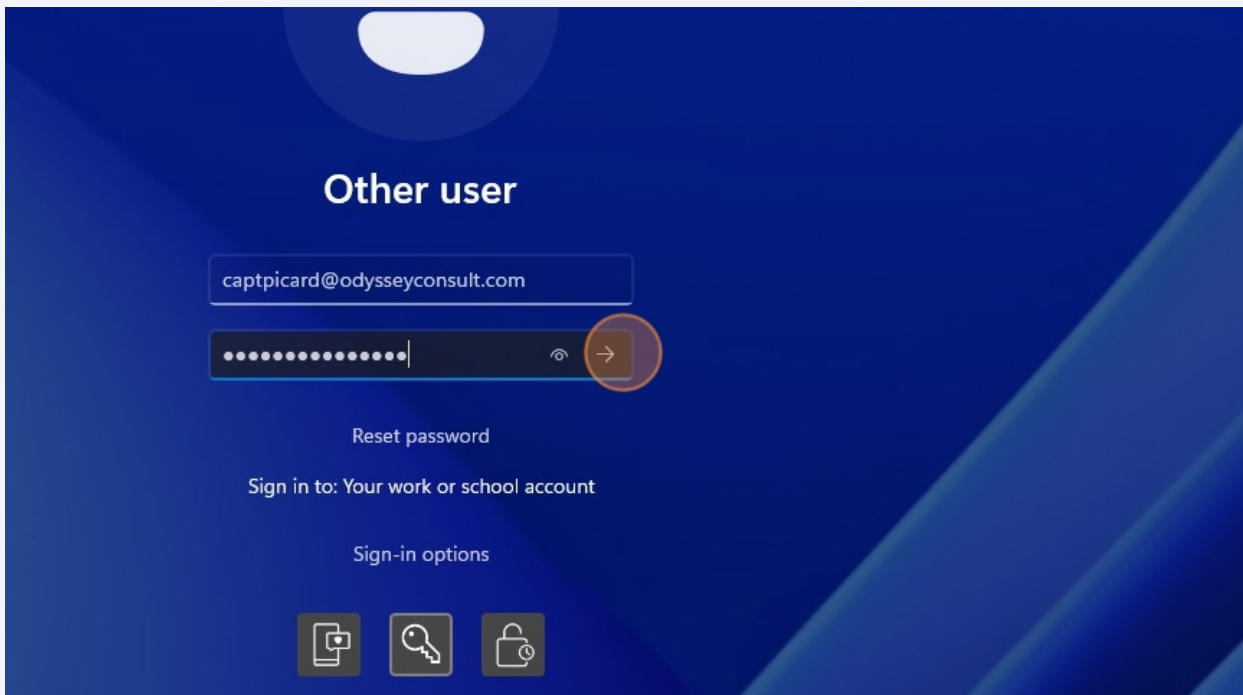

7

Huzzah! You're logged in to your new Microsoft 365 powered computer account.

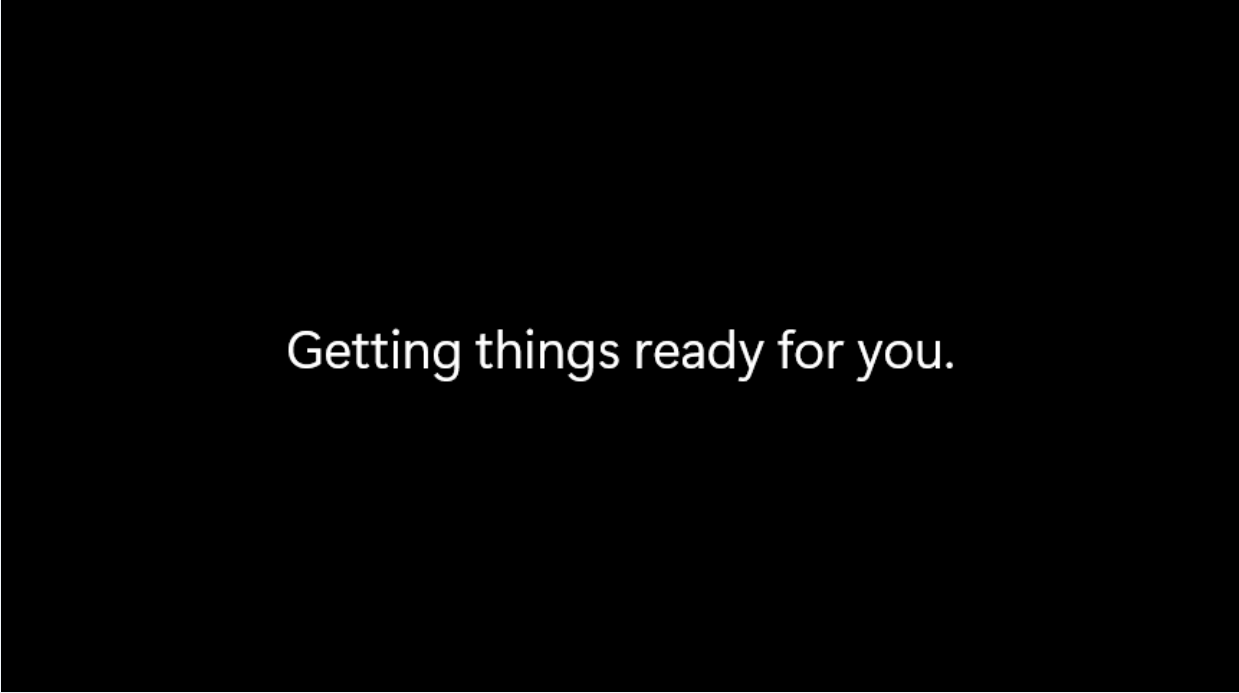

Getting things ready for you.

8